

⊗ DIFFERENT FROM MOTOR MANUFACTURER
 - DIRECTION AND PORTS LOCATION ARE REVERSIBLE

FLANGES DIN 2633 PN 400

REF	DESCRIPTION	MATERIAL	CODE
10	Containment shell	TITANIUM	
20	Ext. Magnet	CoSm/ Carbon Steel	
30	Int. Magnet	SS 316L/CoSm	
40	Impeller	SS 316L	
50	Set O-Rings (a+b+c) a + b = O-Ring 4337 (237) c = O-Ring 4400 (242)	METALLIC	
61	Thrust Bearings	Pcarbon	
62	Rear Ring	SS316L	
70	Shaft	SS316 H.C.	
75	Sleeve Bearings Bearings (d+e) Bearing (f)	SIC SS316	
78	Bracket (200-130-24)	CARBON STEEL	
79	Rub Ring	Bronze	
84	End Cover	SS 316L	
85	Pump Casing	SS 316L	
88	Rear Wet End (10+30+40+50+61+62+70+75)	/	

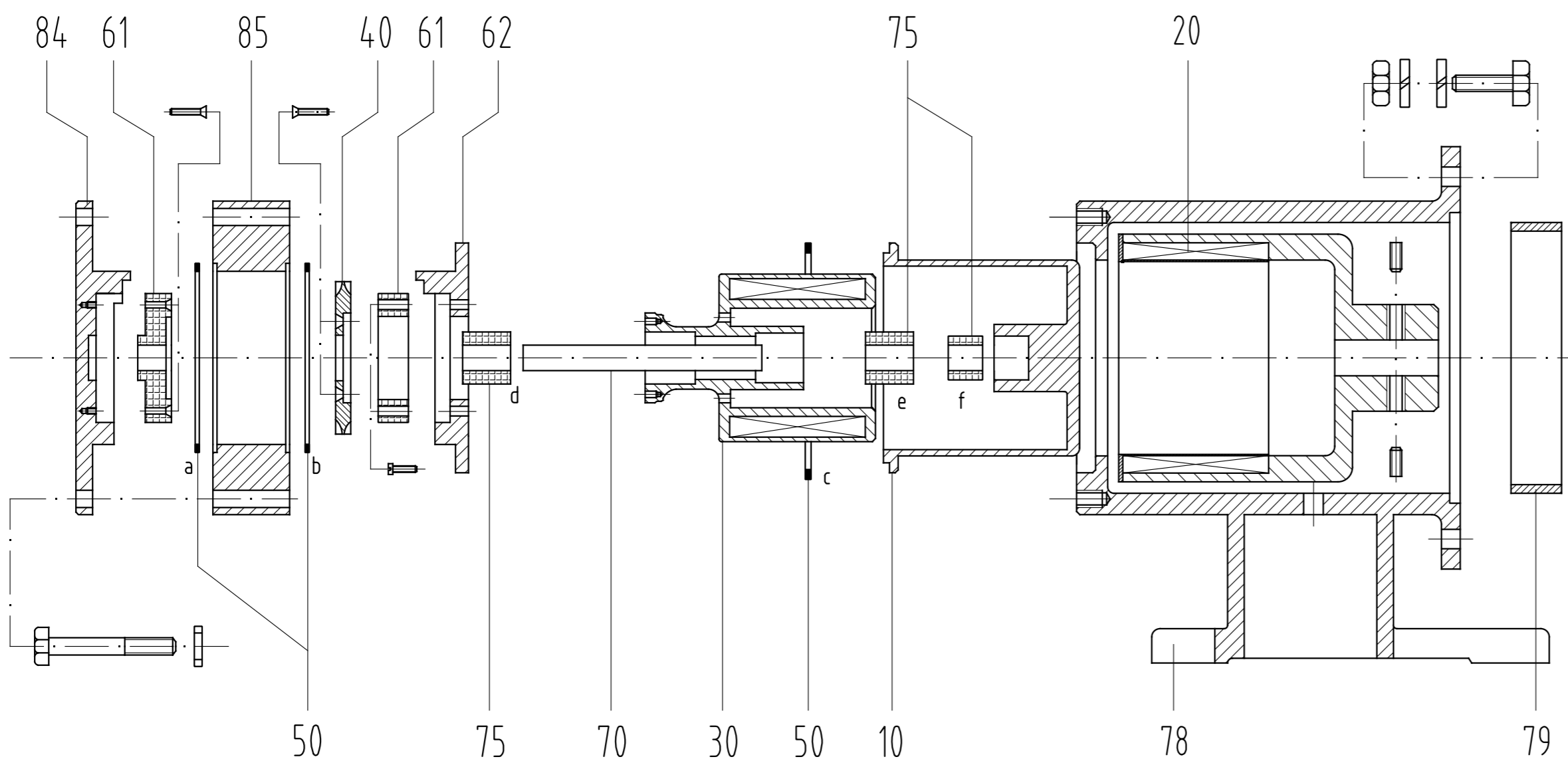

Alle Angaben unverbindlich, technische Änderungen vorbehalten! Technical data not binding and subject to change!
 Copyright MARCH PUMPEN GmbH & Co.KG 2019

	MARCH PUMPEN GmbH & Co.KG Rültenaustraße 2 D-35394 Gießen info@march-pumpen.com www.march-pumpen.com		Allgemeintoleranzen nach DIN ISO 2768-m Alle Kanten gratfrei		
			Datum: 02.07.2019 Name: Lach	Series MTA MTA 49 LC HT/HP	
DPCA-0049-F-HT/HP			1 A2		
Status	Änderungen	Datum	Name		